

- LAND & BOUNDARY KEY:**
- - - EXISTING HIGHWAY BOUNDARY
 - - - PROPOSED HIGHWAY BOUNDARY
- SURFACE FINISHES KEY:**
- RE-SURFACED CARRIAGEWAY
 - PROPOSED CARRIAGEWAY CONSTRUCTION
 - RE-SURFACED OR NEW FOOTWAY
 - NEW SEGREGATED CYCLEWAY
 - SHARED USE FOOTWAY / CYCLEWAY
 - NEW RAISED ENTRY TREATMENT
 - SOFT LANDSCAPING
 - EXISTING CARRIAGEWAY

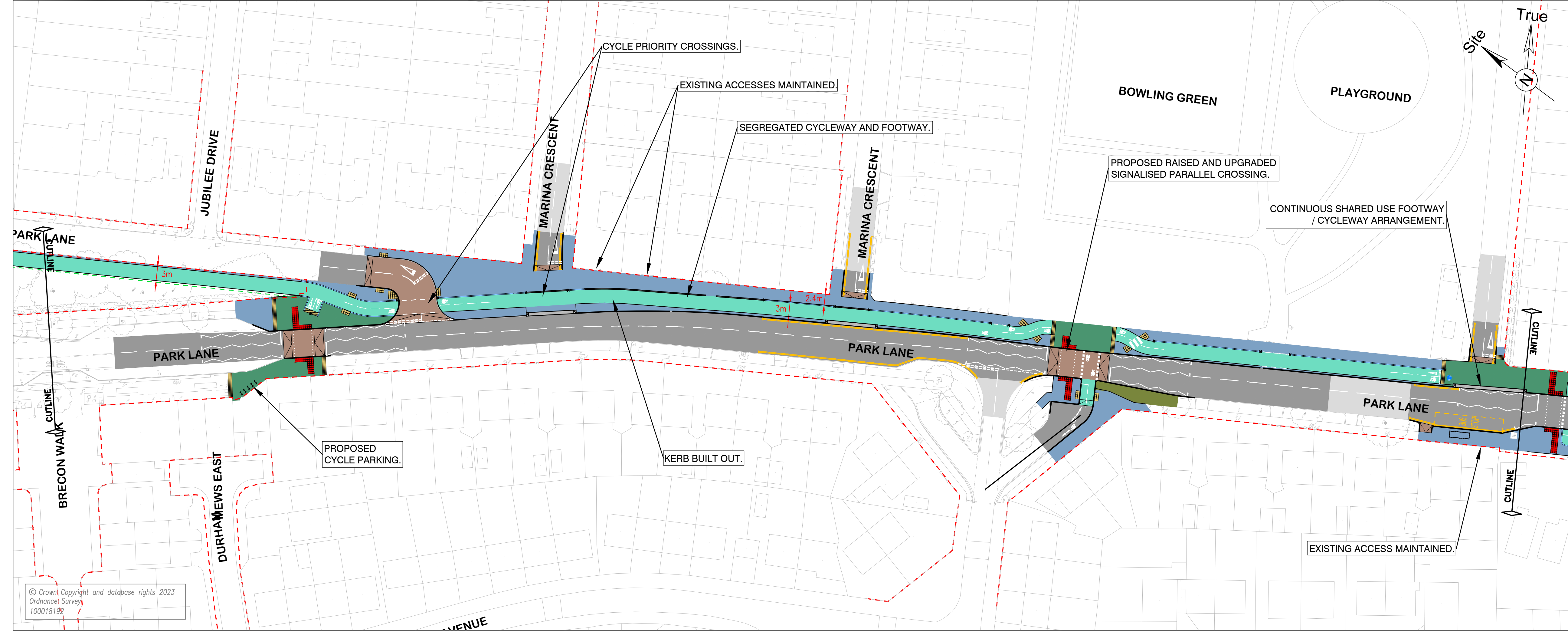

P02	SEFTON AMENDMENTS	04/07/23	DS	CC
P01	FOR CONSULTATION	16/02/23	DS	CC
Rev	Description	Date	Drawn	Approved



Magdalen House, 30 Trinity Road, Bootle, Merseyside, L20 3NJ
Tel: 0151 934 2000

FOR CONSULTATION

Scheme
**MARITIME CORRIDOR
ACTIVE TRAVEL
DETAILED DESIGN**

Drawing Title
**PARK LANE CYCLEWAY
GENERAL ARRANGEMENT
(Sheet 1 of 2)**

Directory	Designed	Drawn	Checked	Date
	DS	DS	CC	15/02/23
Drawing No.	Rev	Scale		
MARIT/AT/PLAT/01	P02	1:500		