

- LAND & BOUNDARY KEY:**
- - - EXISTING HIGHWAY BOUNDARY
 - - - PROPOSED HIGHWAY BOUNDARY
- SURFACE FINISHES KEY:**
- RE-SURFACED CARRIAGEWAY
 - PROPOSED CARRIAGEWAY CONSTRUCTION
 - RE-SURFACED OR NEW FOOTWAY
 - NEW SEGREGATED CYCLEWAY
 - SHARED USE FOOTWAY / CYCLEWAY
 - NEW RAISED ENTRY TREATMENT
 - SOFT LANDSCAPING
 - EXISTING CARRIAGEWAY

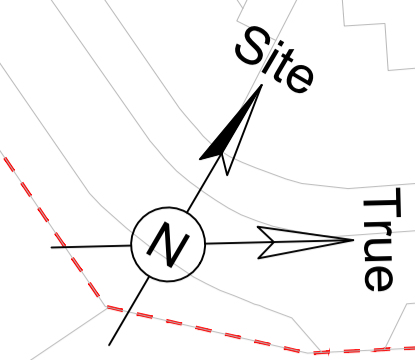

SEFTON ACTIVE TRAVEL PROPOSALS TO BE TIED-IN TO THE NATIONAL HIGHWAYS TEMPORARY CROSSING POINT IN THE INTERIM. NATIONAL HIGHWAYS TO RE-DESIGN THE PARK LANE JUNCTION AND SEFTON AND NH PROPOSALS COORDINATED ONCE AVAILABLE.

P03	SEFTON AMENDMENTS	04/07/23	DS	CC
P02	LCA AMENDMENTS	12/05/23	DS	CC
P01	FOR CONSULTATION	16/02/23	DS	CC
Rev	Description	Date	Drawn	Approved



FOR CONSULTATION

Scheme
**MARITIME CORRIDOR
 ACTIVE TRAVEL
 DETAILED DESIGN**

Drawing Title
**DUNNINGS BRIDGE ROAD CYCLEWAY
 GENERAL ARRANGEMENT
 (Sheet 2 of 2)**

Designed	DS	Drawn	DS	Checked	CC	Date	15/02/23
Drawing No.	MARIT/AT/DUNR/02	Rev	P03	Scale	1:500		